

10 9 8 7 6 5 4 3 2 1

F
E
D
C
B
A

F
E
D
C
B
A

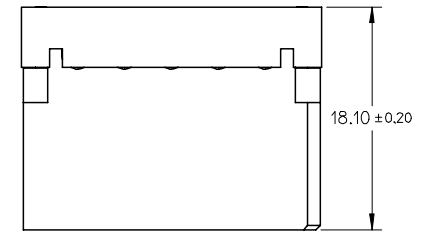
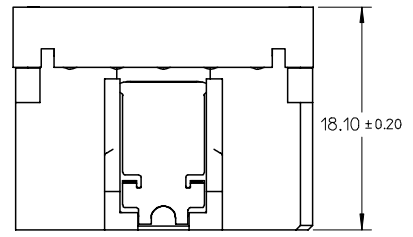
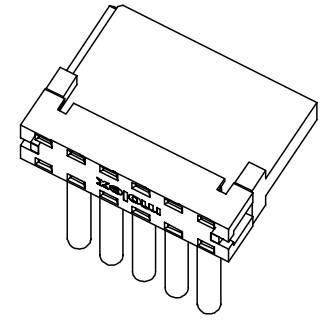
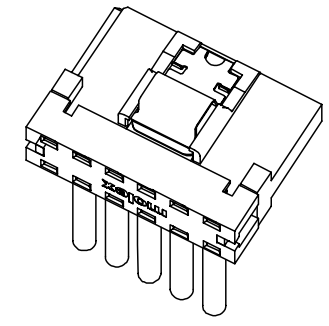
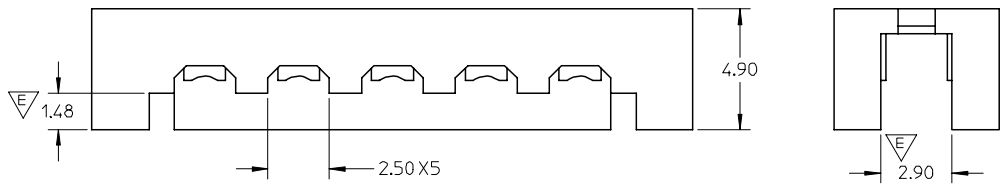
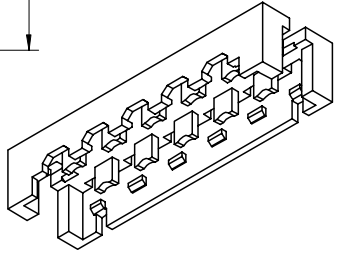
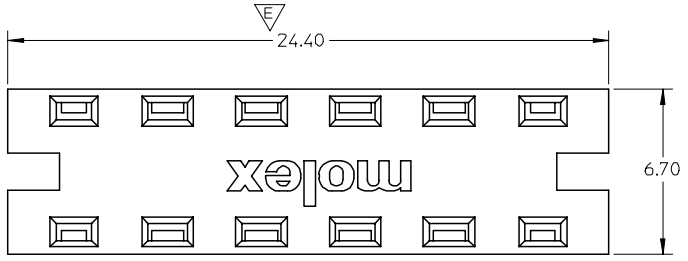

APPLICATION FOR WITH LATCH TYPE

APPLICATION FOR WITHOUT LATCH TYPE

- NOTE**
- 1 MATERIAL: THERMAL PLASTIC, COLOR: BLACK UL94V-0.
 - 2 THIS COVER IS FEED TO TYPE, IT IS AVAILABLE FOR 67926-000*/002*(WITH LATCH), 67926-001*(WITHOUT LATCH).
 - 3 PACKAGE SPEC:
 - 3.1 1000 PCS IN ONE BAG.
 - 3.2 3000 PCS(3 PAGES) IN ONE INNER CARTON.
 - 3.3 12,000 PCS(4 INNER CARTONS) IN ONE OUTER CARTON.

REVISED EC NO: SH2007-0742 DRWN: BCHENZ6 CHKD: JTIAN APPR: JNCHEN	2007/04/13 2007/04/16 2007/05/04	QUALITY SYMBOLS ▽=0 ◻=0	GENERAL TOLERANCES (UNLESS SPECIFIED)		DIMENSION STYLE MM ONLY		SCALE 5:1	DESIGN UNITS METRIC	THIRD ANGLE PROJECTION		
			mm	INCH	DRAWN BY GRATE MA	DATE 2004/04/25	TITLE FEED TO COVER FOR SATA POWER CONNECTOR IDT TYPE				
			4 PLACES ± ---	± ---	CHECKED BY YA JUN	DATE 2004/04/25					
			3 PLACES ± ---	± ---	APPROVED BY SAM	DATE 2004/04/25	MOLEX INCORPORATED DOCUMENT NO. SD-67926-003 SHEET NO. 1 OF 1				
		2 PLACES ± 0.15	± ---	MATERIAL NO. 67926-0040							
		1 PLACE ± 0.25	± ---	DRAFT WHERE APPLICABLE MUST REMAIN WITHIN DIMENSIONS		SIZE A3		THIS DRAWING CONTAINS INFORMATION THAT IS PROPRIETARY TO MOLEX INCORPORATED AND SHOULD NOT BE USED WITHOUT WRITTEN PERMISSION			
		ANGULAR ± 1 °									

9 8 7 6 5 4 3 2 1